

ATTACH 48" 1 1/8" APA RIM OR MIN.
1 1/4" LVL ON EITHER SIDE GLUED
AND NAILED w/ 16d SINKER @ 6" c/c
TO TOP AND BOTTOM FLANGES

LARGE SIDE NOTCH IN TOP
FLANGE CENTER REPAIR AT
NOTCH LOCATION

FILLER BLOCKS w/ 3
ROWS OF 16d (0.131" x 3")
NAILS TO WEB

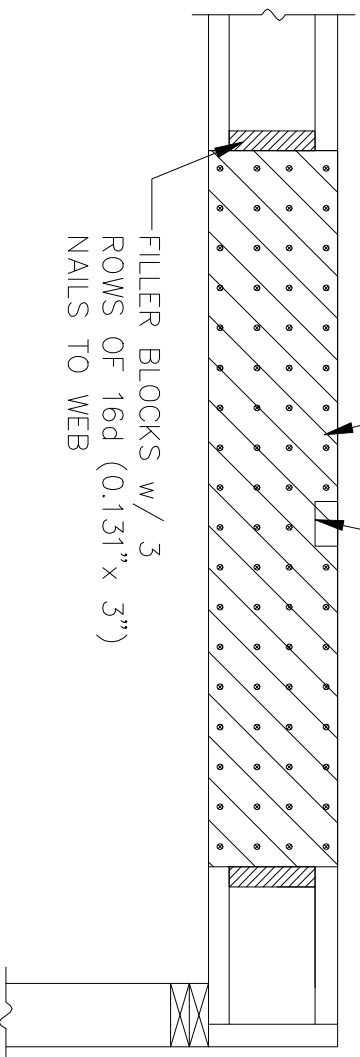

REPAIR DETAIL FOR TOP
FLANGE NOTCH AT CENTER
SPAN OF JOISTS

ALL GLUED AND NAILED

NOTE:
DAMAGE TO I-JOIST FLANGE
AND/OR WEB CAN CAUSE
FAILURE OF FLOOR SYSTEM.
SPAN, SPACING AND LOADING AS
WELL AS EXTENT AND LOCATION
OF DAMAGE ALL AFFECT THE
REPAIR REQUIRED.
EACH CASE SHALL BE REVIEWED.

2 ROWS OF 16d COMMON
NAILS @ 6" c/c CLINCHED

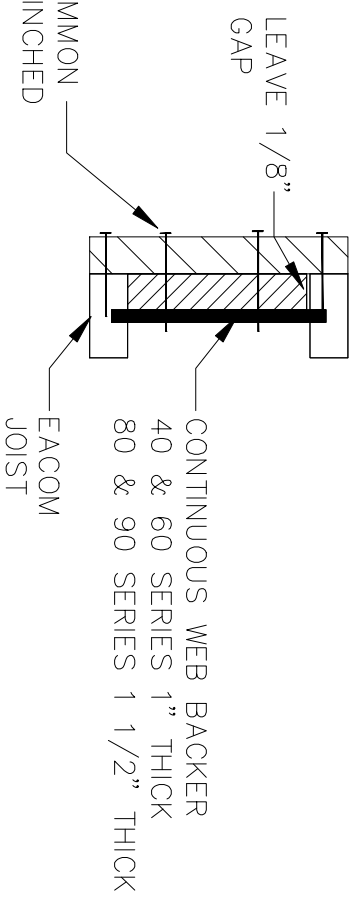

TYPICAL REPAIR DETAIL "F"